

DEW

INSTALLATION INSTRUCTIONS

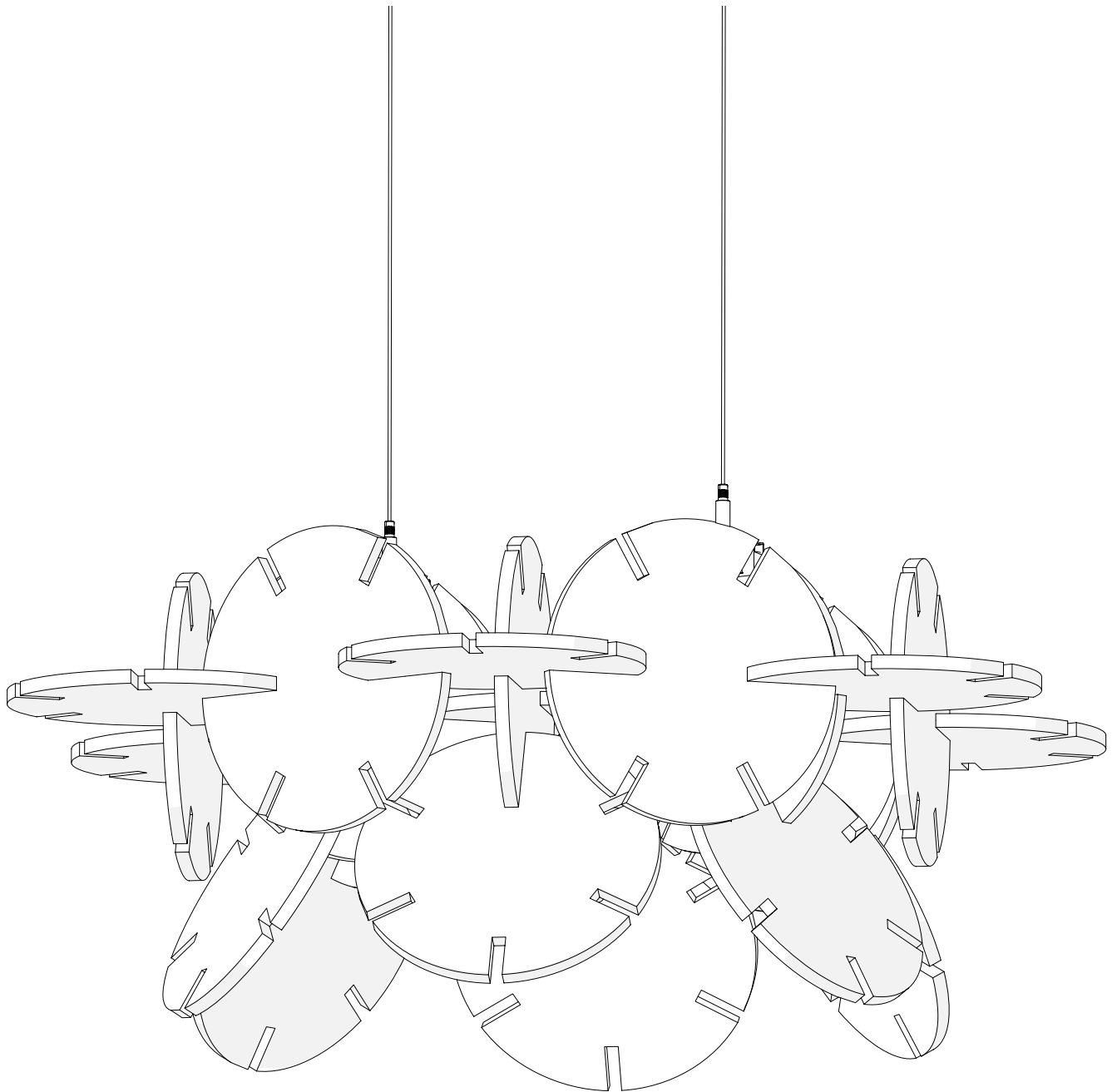

DEW: COMPONENTS AND HARDWARE

DEW droplet sizes and quantities will depend on which size variation of DEW you have selected for shipment:

DEW: Small

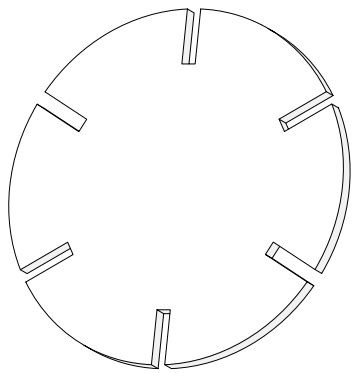

200mm
Droplet

x66

INCLUDED HARDWARE

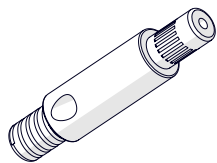

Grip lock x4

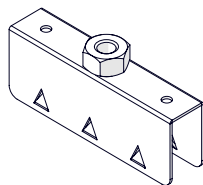

Saddle bracket x4

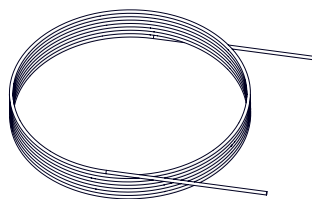

Aircraft Cable 6ft

DEW: Large

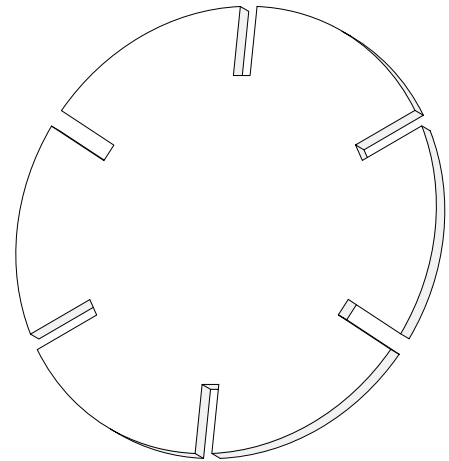

300mm
Droplet

x28

INCLUDED HARDWARE

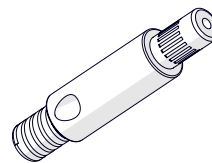

Grip lock x2

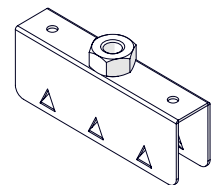

Saddle bracket x2

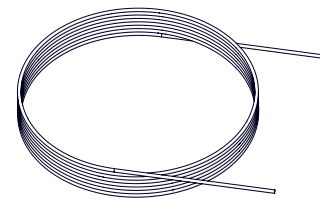

Aircraft Cable 3ft

DEW: INSTALLATION INSTRUCTIONS

Follow these steps to assemble DEW.

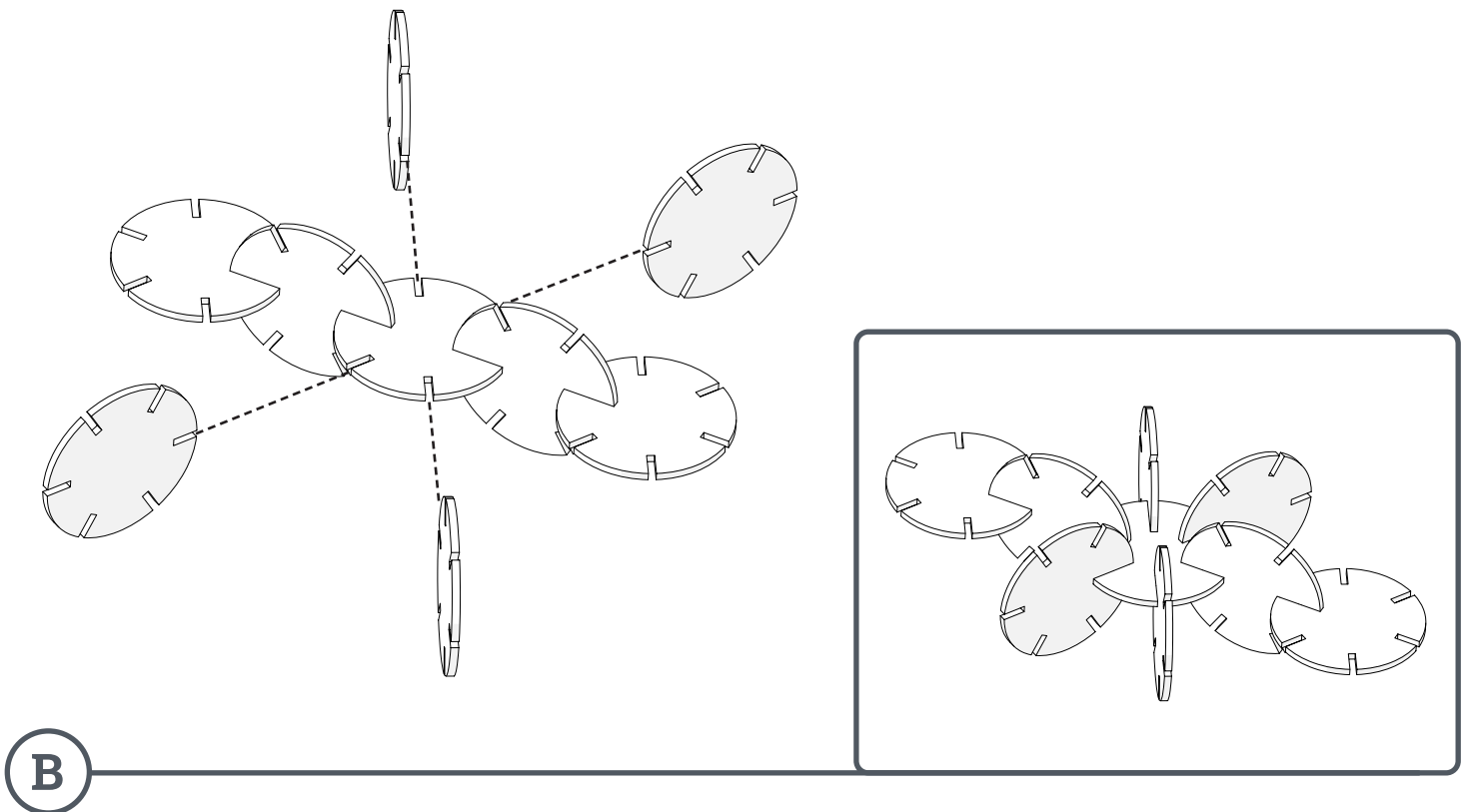
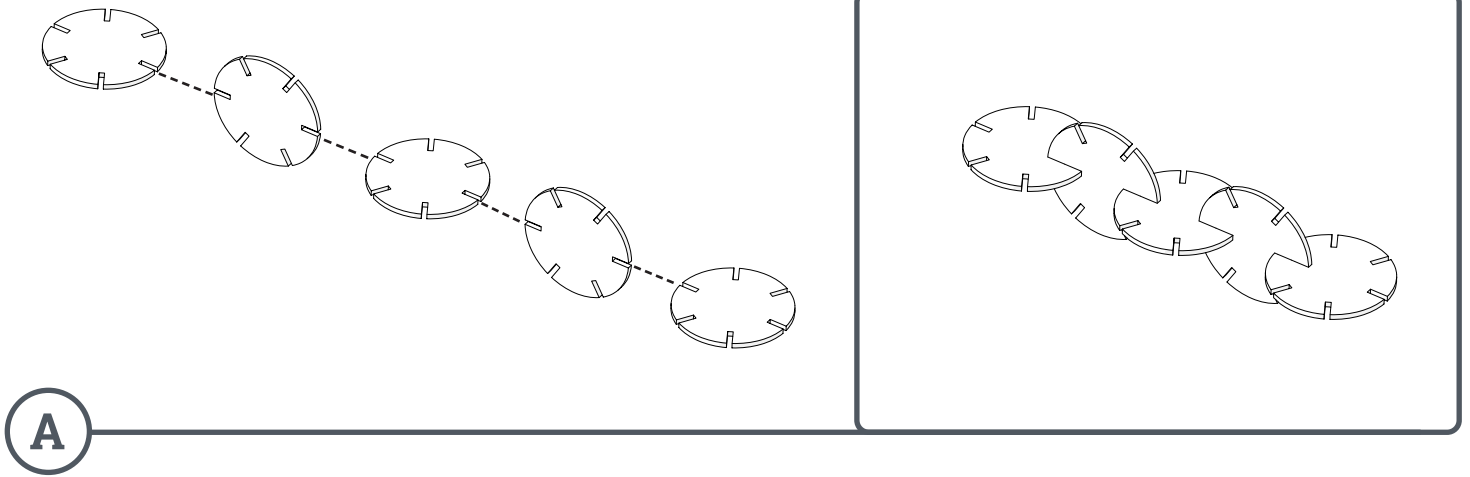

DEW: INSTALLATION INSTRUCTIONS

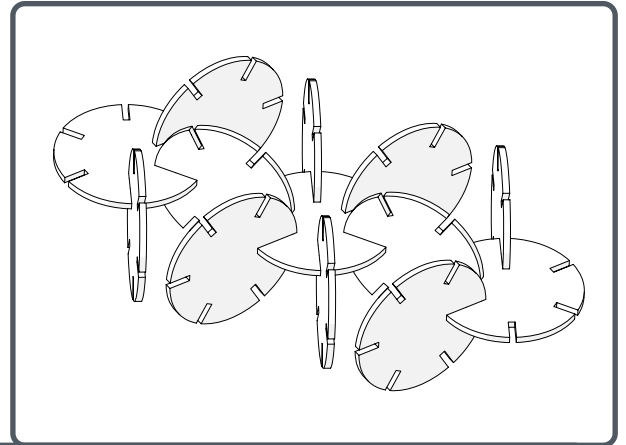
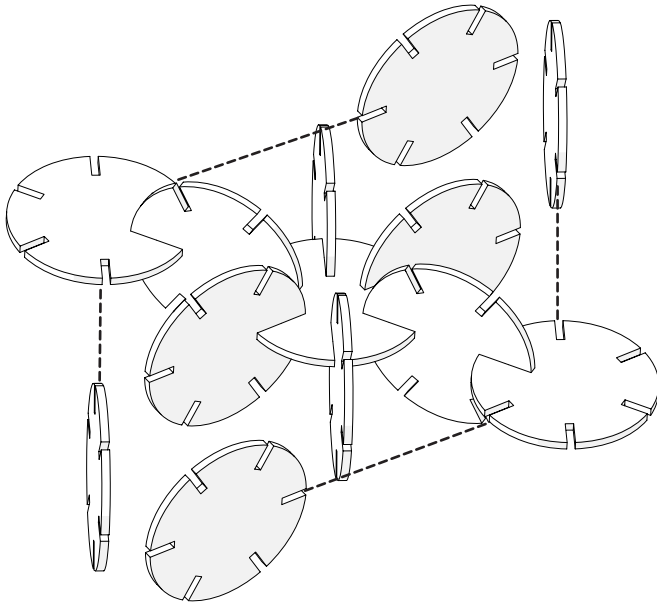

C

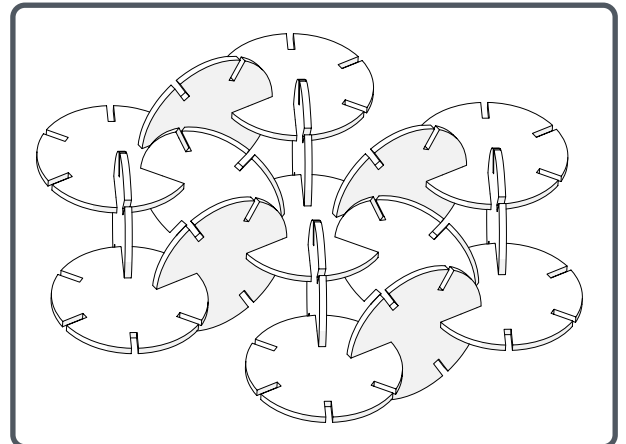
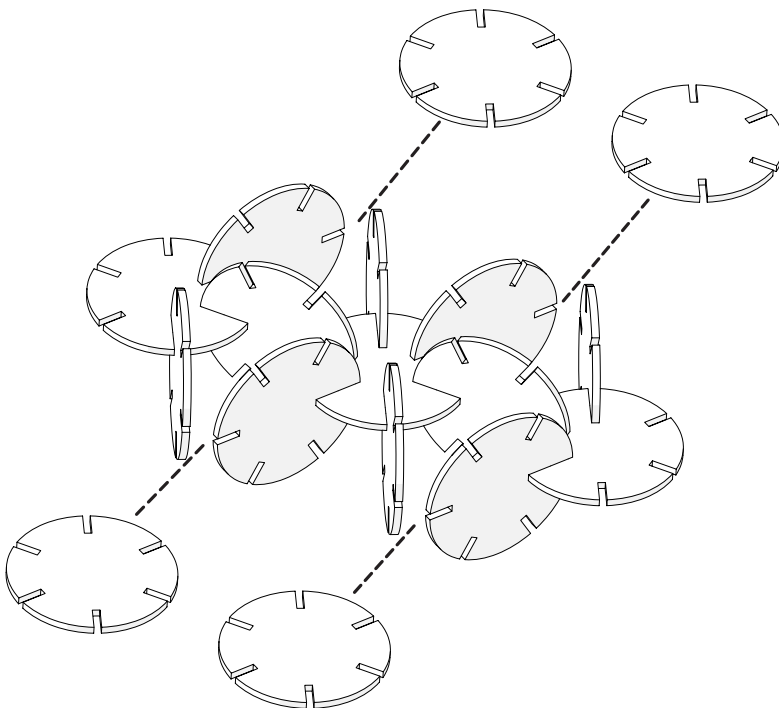

D

DEW: INSTALLATION INSTRUCTIONS

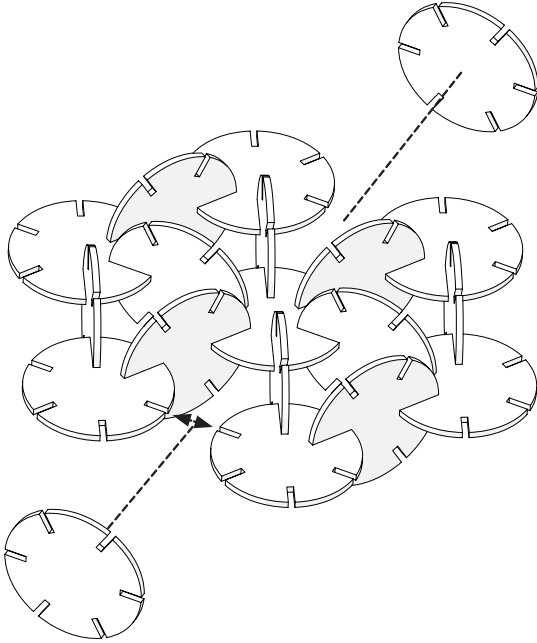

E

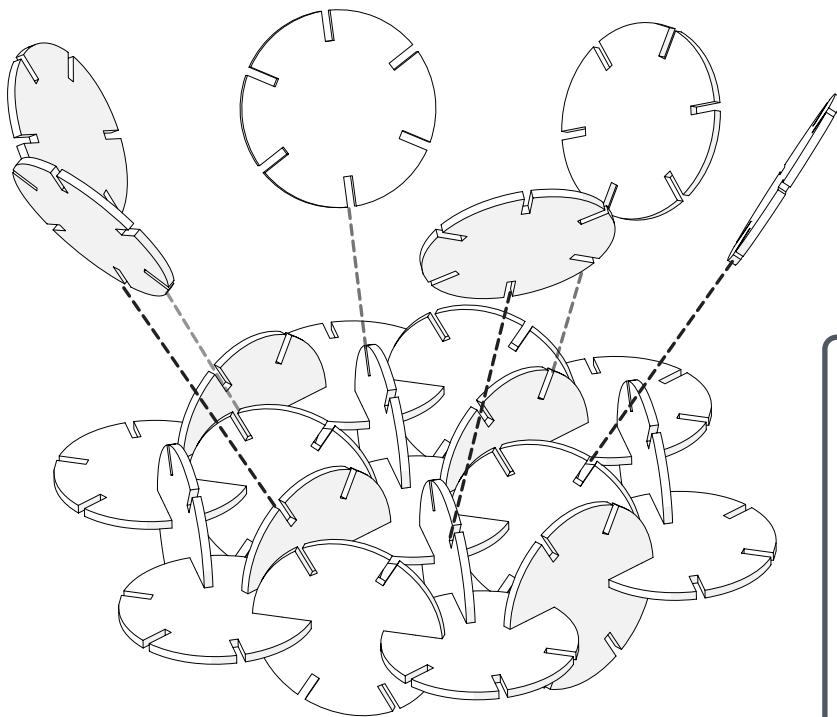
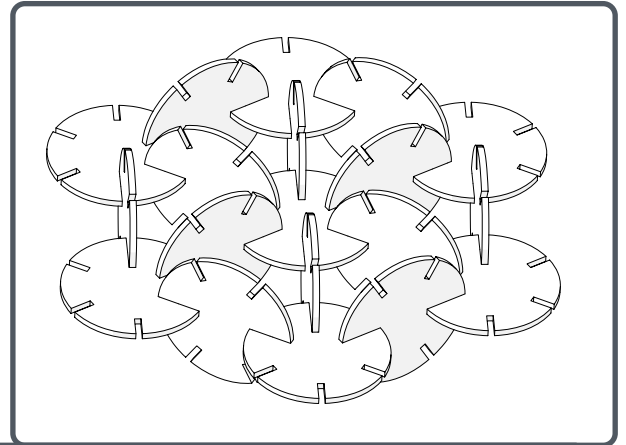

F

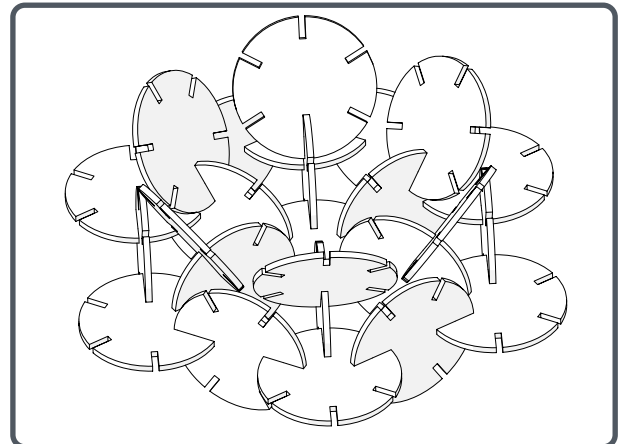

DEW: INSTALLATION INSTRUCTIONS

Assemble hardware as shown [x4].

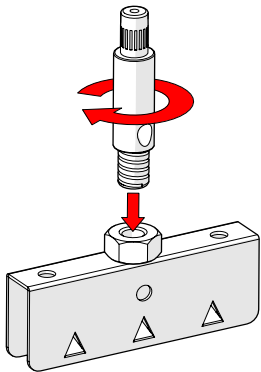

Screw the Grip Lock to the saddle bracket.

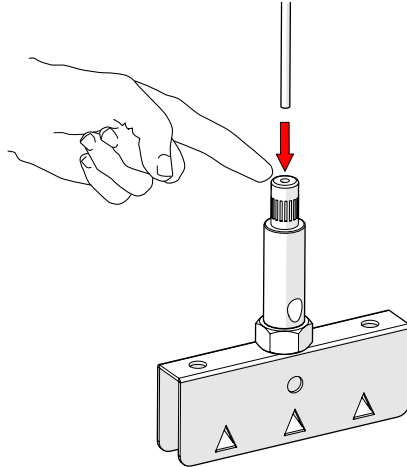

Press down on the plunger while inserting cable.

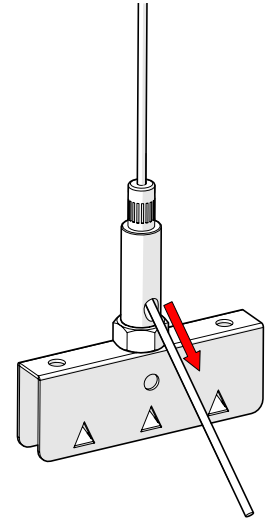

Thread cable through the side exit, and release the plunger to lock the cable in place.

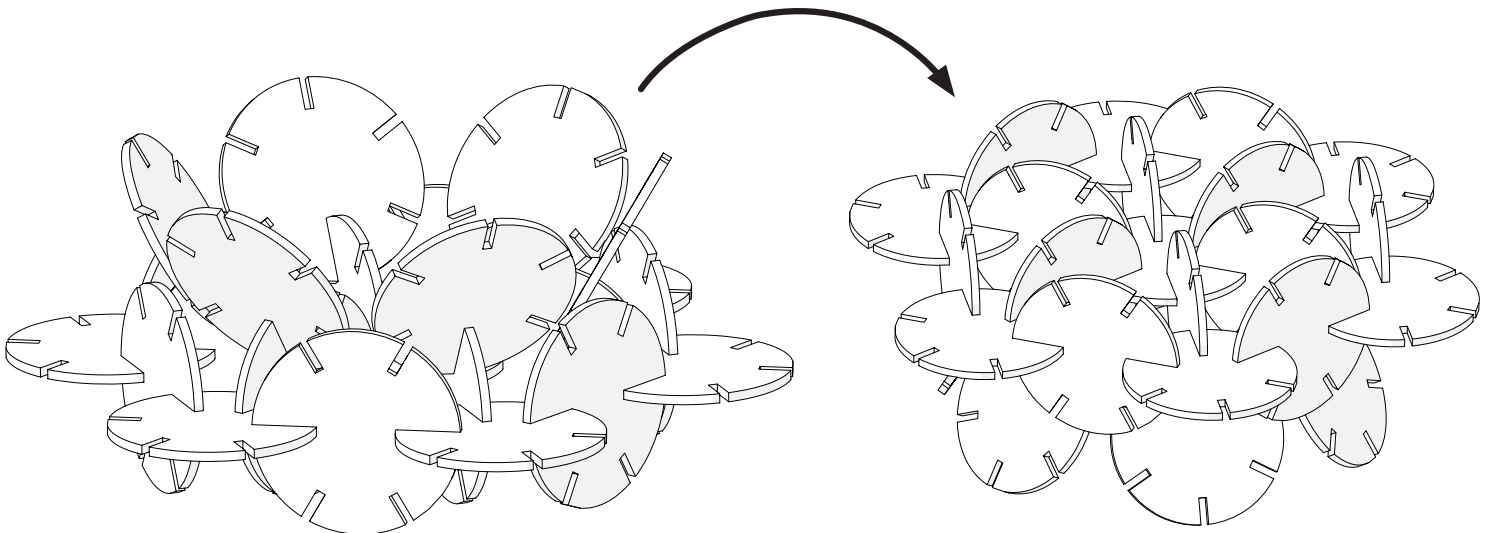

Flip the module over to continue with hardware installation,

DEW: INSTALLATION INSTRUCTIONS

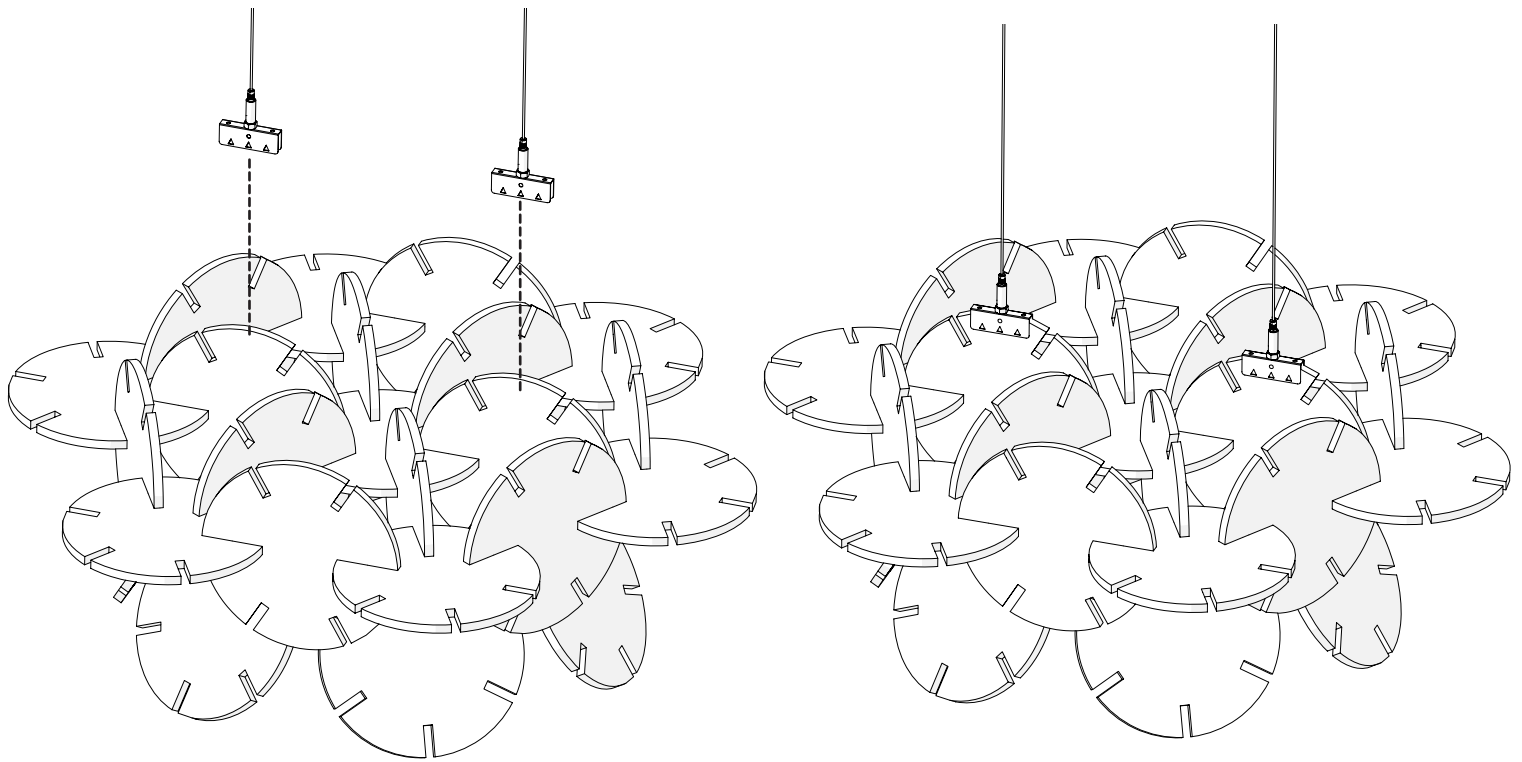

Press the spikes of the saddle brackets firmly into the tops of the center droplets, and hang DEW according to your preferred method.

DEW: INSTALLATION INSTRUCTIONS

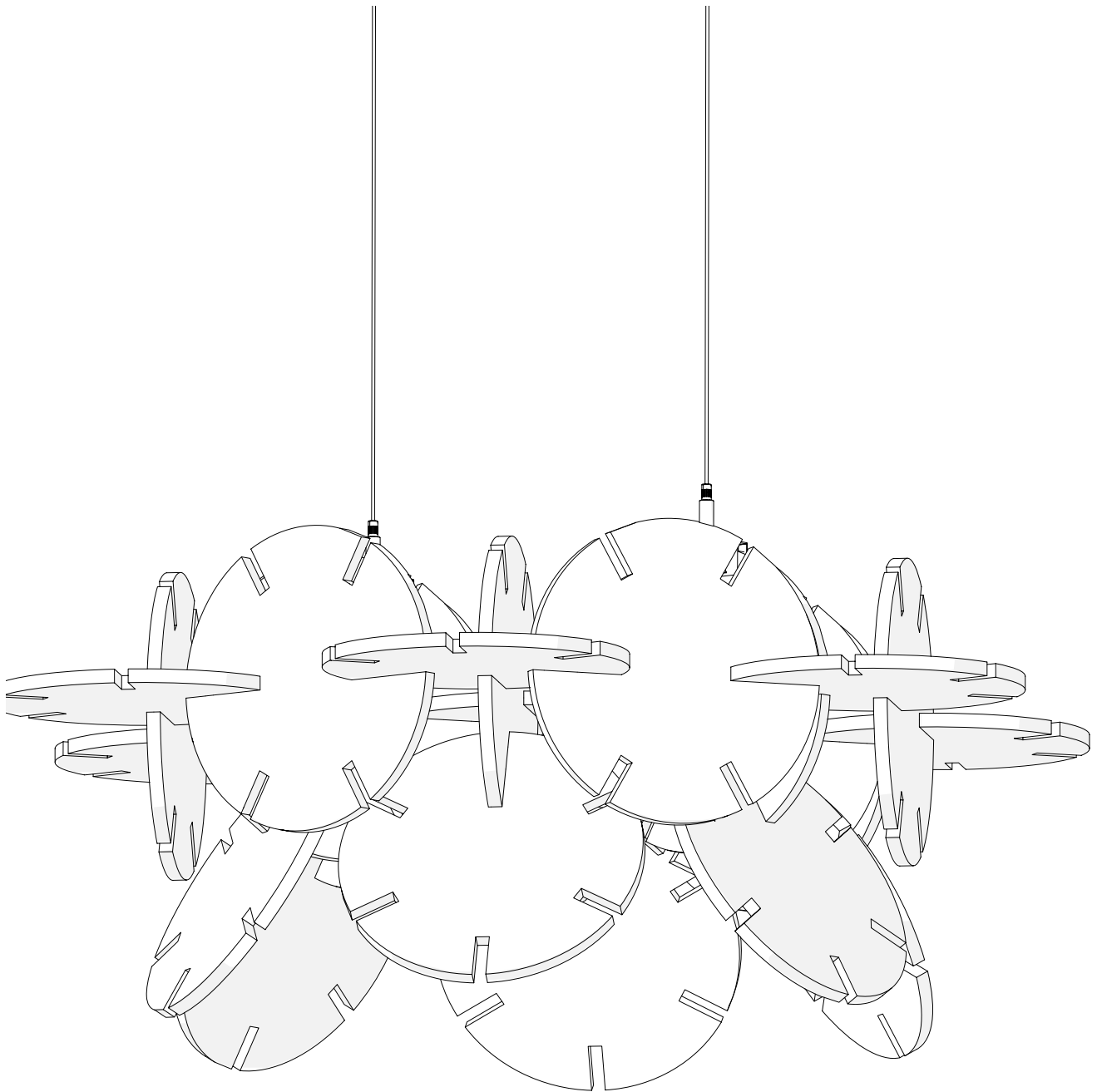

Installation Complete.