

RIPL: ASSEMBLY INSTRUCTIONS

ACOUSTICAL BAFFLE

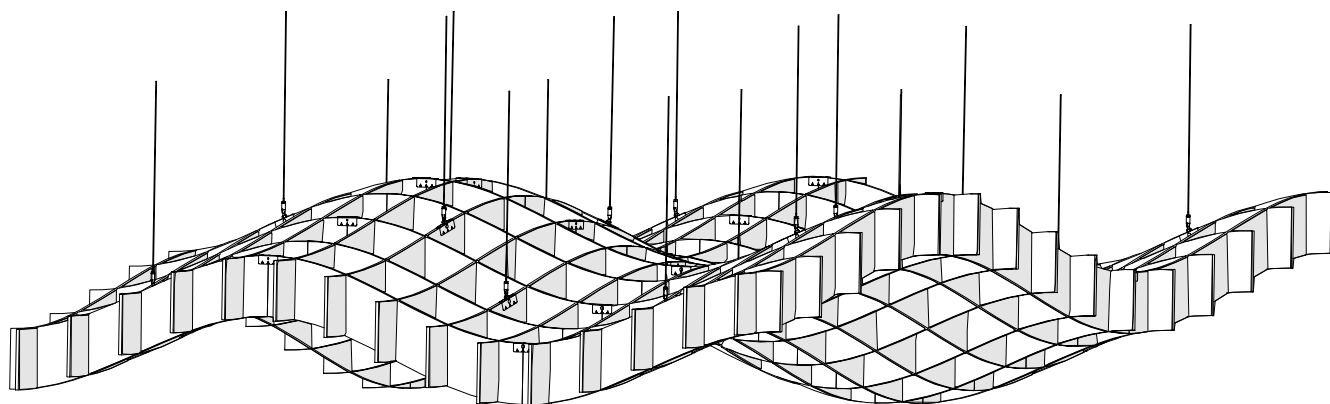

TOOLS REQUIRED

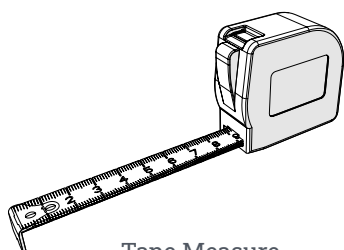

Tape Measure

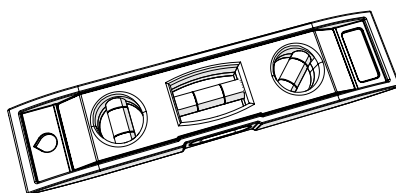

Level

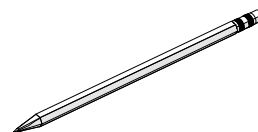

Pencil/Marker

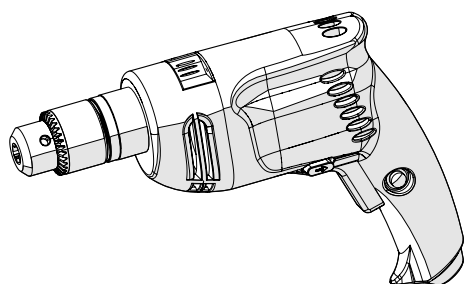

Power Drill

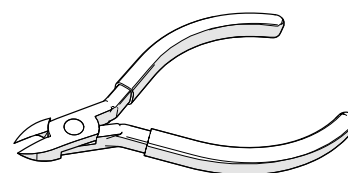

Wire Cutters

RIPL: INCLUDED COMPONENTS & HARDWARE

STANDARD HARDWARE

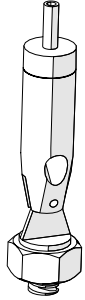

Jointed Gripper [x18]

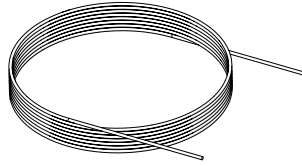

Aircraft Cable [27ft]

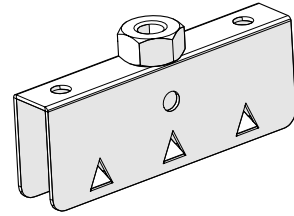

Spike Bracket [x18]

Standard hardware shown does not include direct to ceiling, wall or floor hardware. All customers of Fräsch products are responsible for the selection of final surface mounting hardware.

Please contact support@frasch.com to review your unique site conditions and select the appropriate hardware package.

INCLUDED COMPONENTS

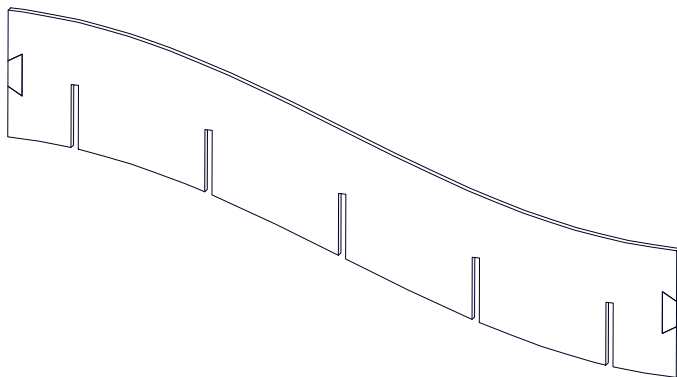

RIPL Fin [x90]

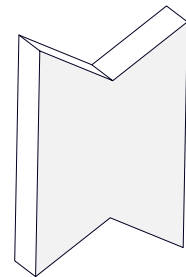

Bowtie Connector [x40]

RIPL: ASSEMBLY INSTRUCTIONS

ASSEMBLING THE MODULE

Step 1: RIPL is assembled from 9 identical “modules” formed by joining 10 fins together at the slot openings. Follow the illustration below to complete the module assembly.

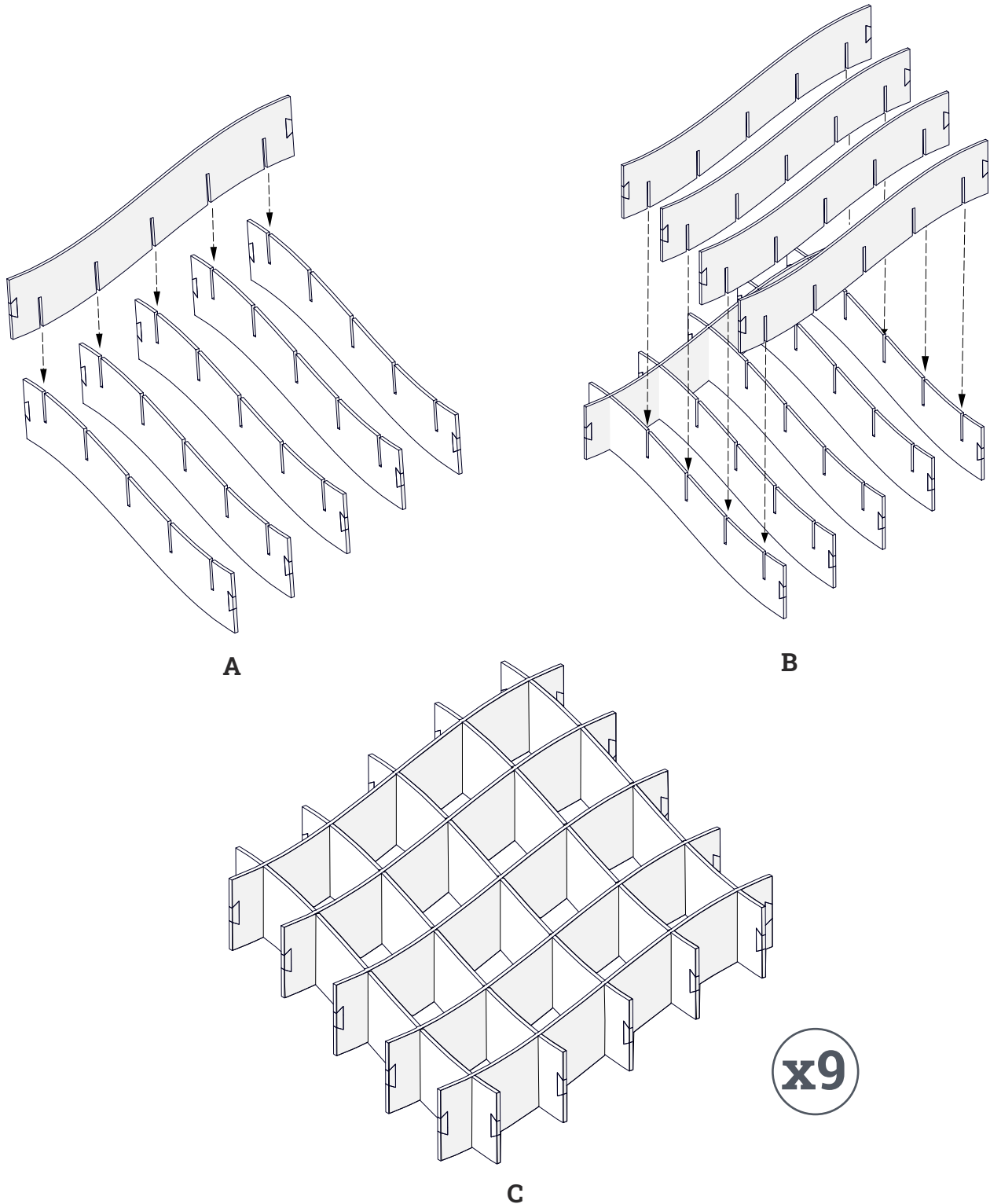

RIPL: ASSEMBLY INSTRUCTIONS

INSTALLING THE SPIKE BRACKETS

Step 2: Assemble the jointed gripper to spike bracket as shown, and firmly press the brackets onto the fins at the spacing shown in the diagram below (2 bracket assemblies per module).

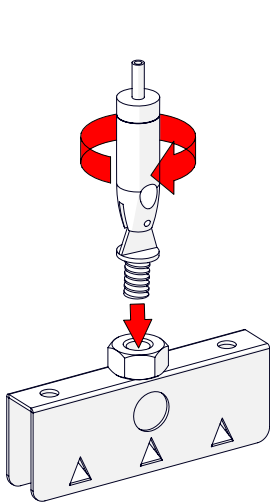

Screw gripper into the hex nut welded to the spike bracket

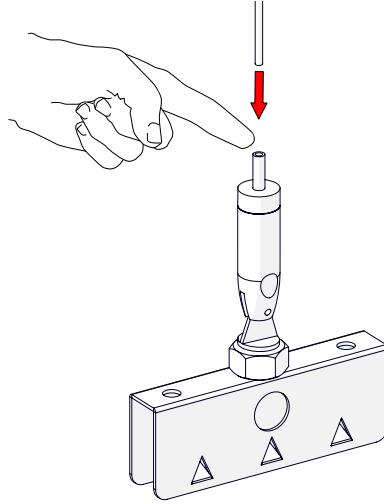

To insert the aircraft cable into the gripper, press firmly on the nipple while threading the cable through the channel. Release the nipple to lock the cable in place.

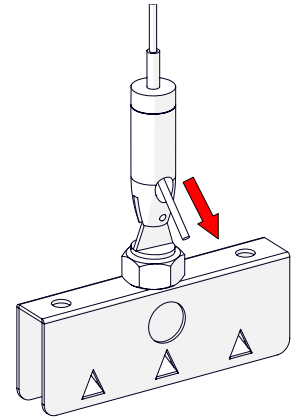

Cut any excess cable with wire cutters once module is level.

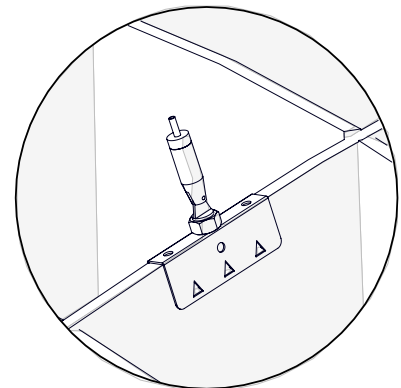
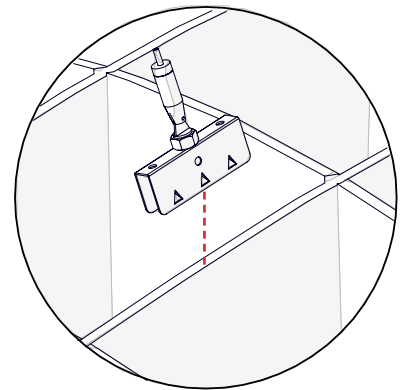
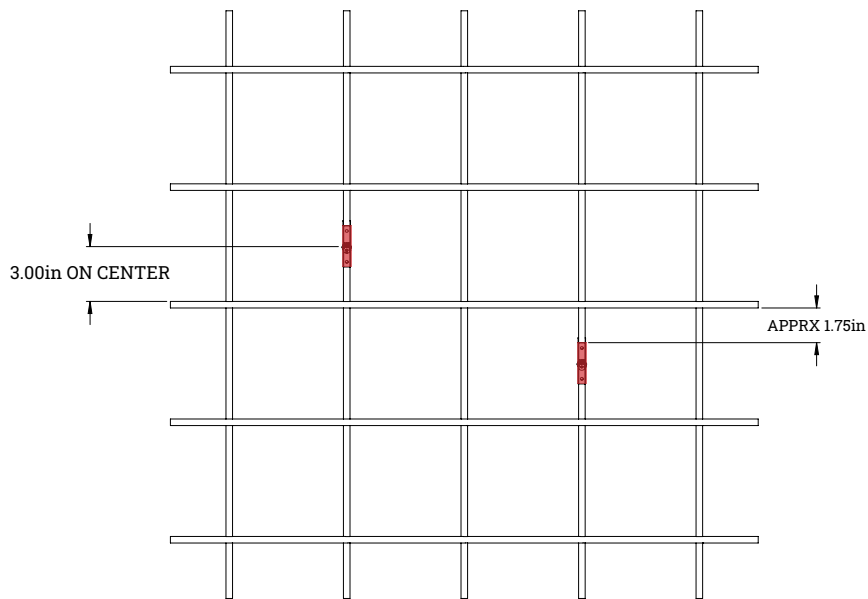

RIPL: ASSEMBLY INSTRUCTIONS

HARDWARE LOCATION GRID

Refer to this diagram to mark the ceiling mounting points with a laser. The red dots correspond to the jointed gripper locations detailed in step 2.

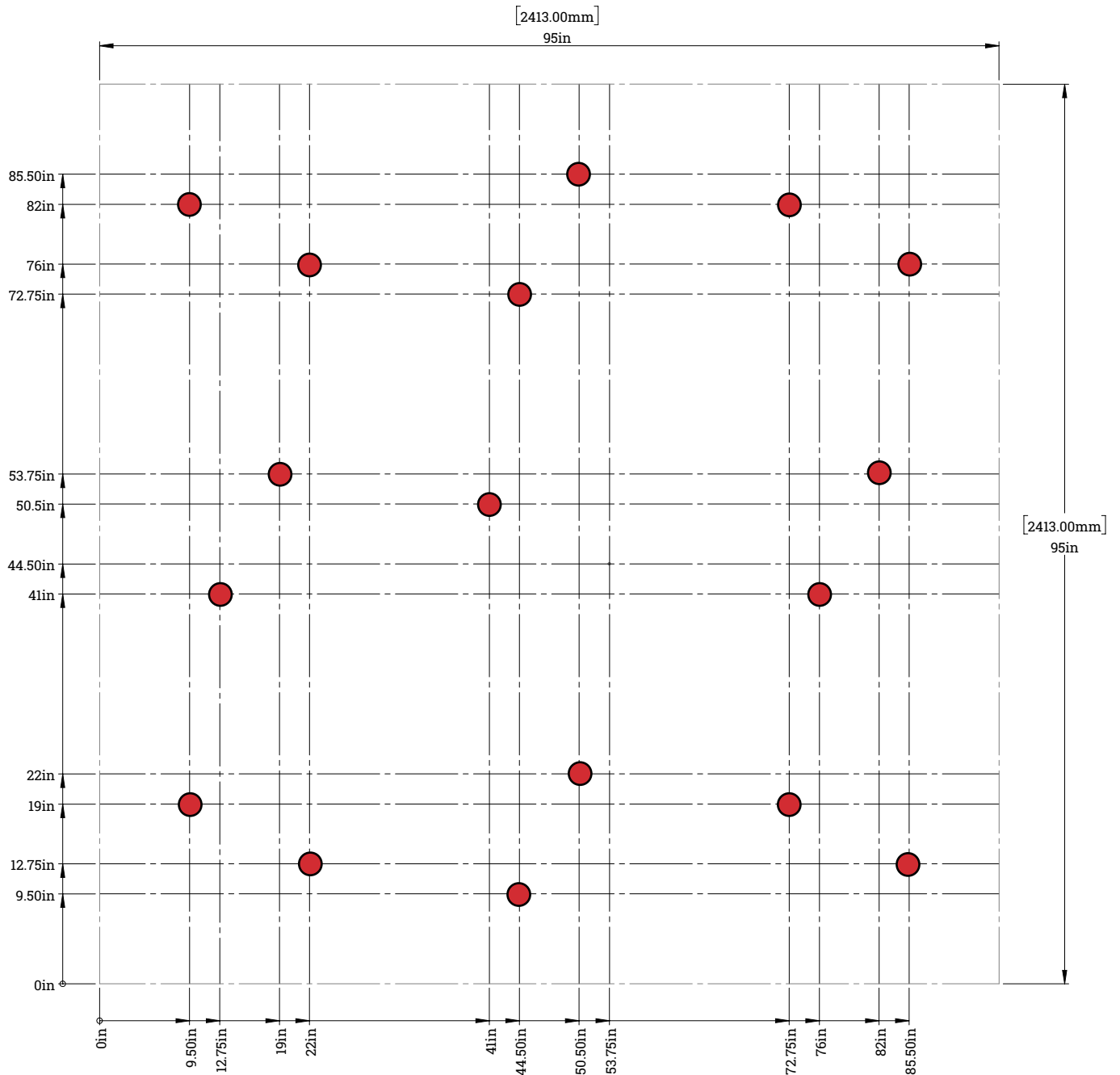

RIPL: ASSEMBLY INSTRUCTIONS

CONNECTING THE MODULES

Step 3: Remove the inserts from the dovetail slots at the end of each fin where the modules will connect.

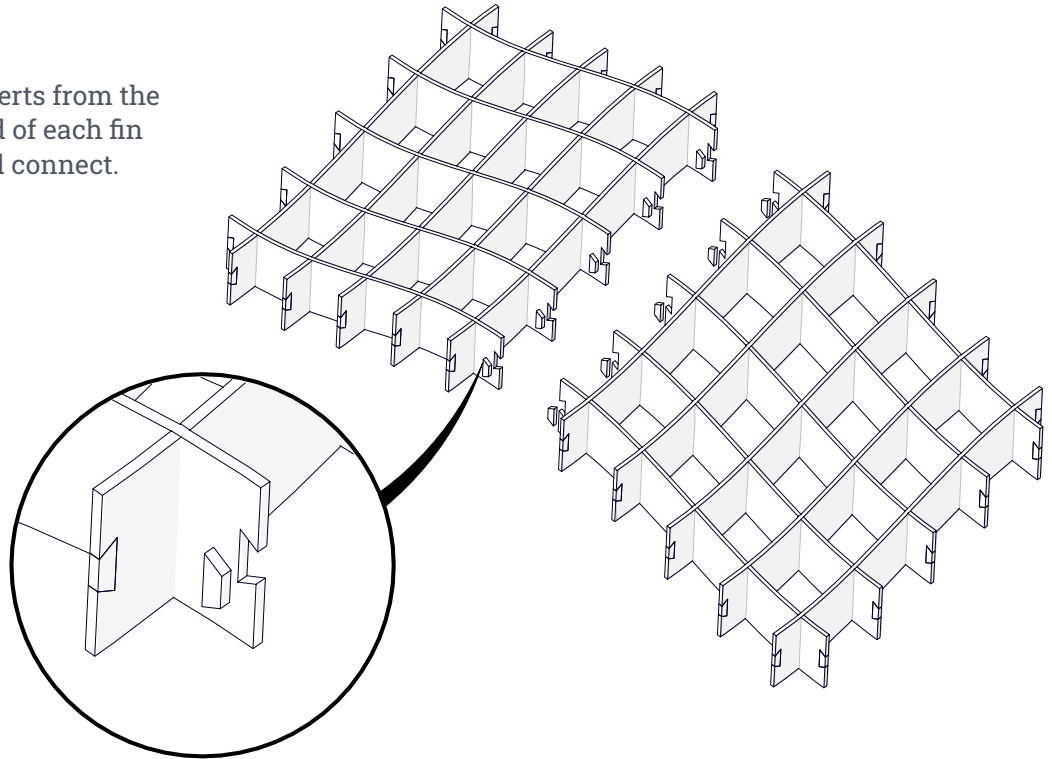

Step 4: Use the bowtie connector to join the fins together, as shown,

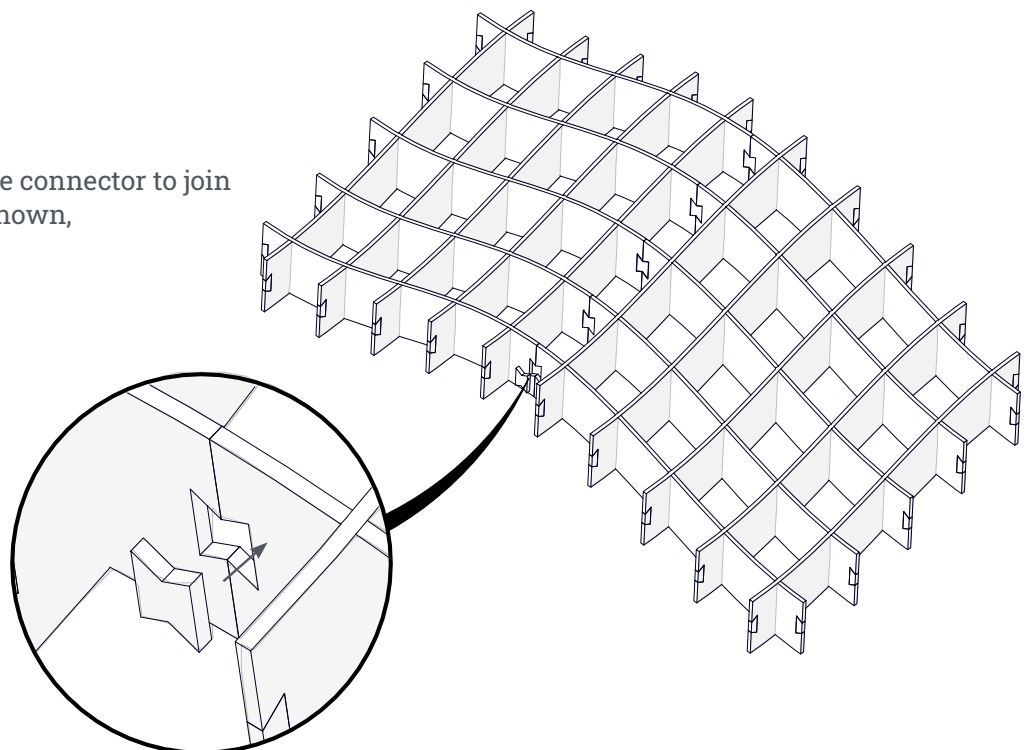

RIPL: INSTALLATION INSTRUCTIONS

CONNECTING & HANGING THE MODULES

Step 5: Repeat steps 3 & 4 to create a 3 module strip. Repeat this process to create 3 strips.

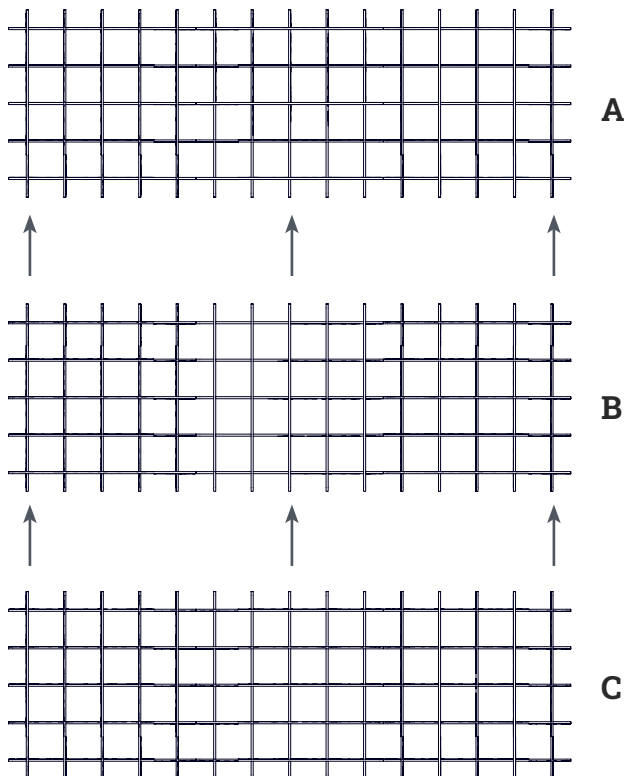
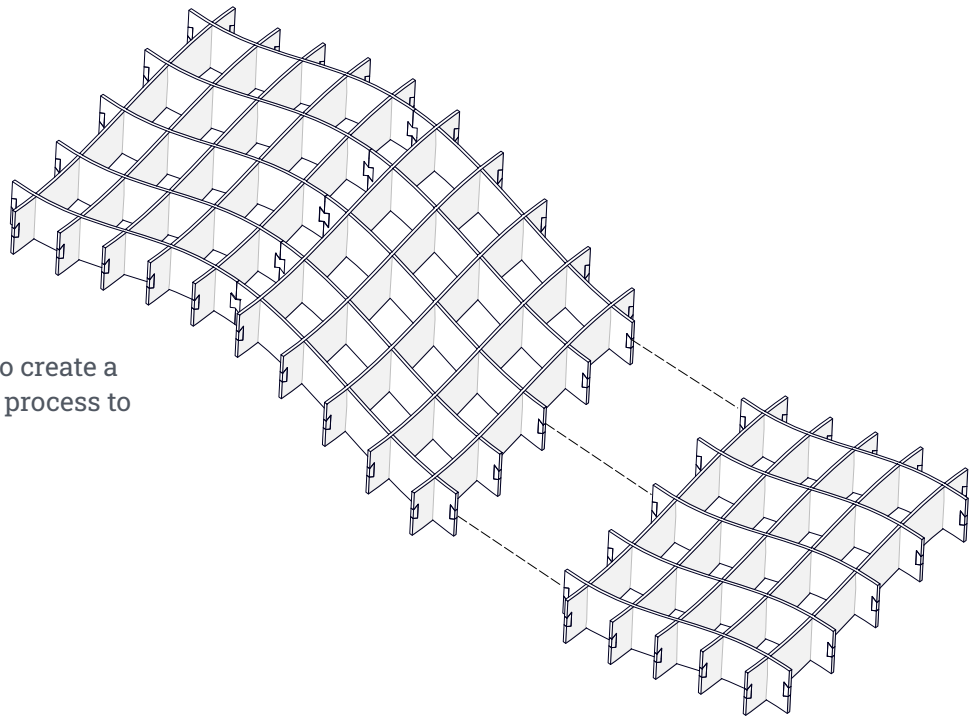

Step 6: Hang and level the first strip, then hang, level and connect the remaining module strips.

RIPL: ASSEMBLY INSTRUCTIONS

INSTALLATION COMPLETE

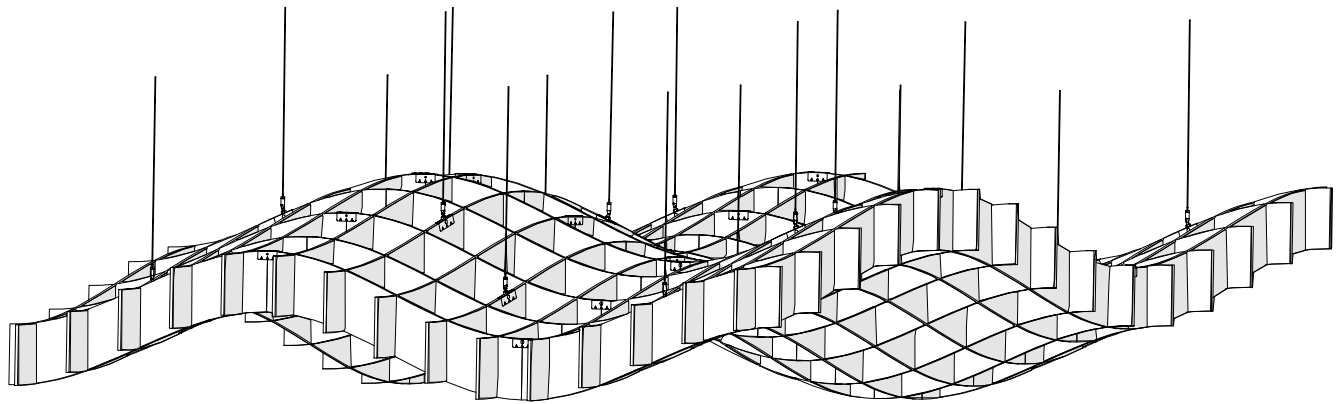

For questions, concerns or help with installation,
contact support@fräsch.com